

Roberts Street, Eccles

Manchester



In Excess of £200,000

Roberts Street

Eccles, Manchester

The PERFECT FIRST HOME offering TWO RECEPTION ROOMS, TWO BEDROOMS, FITTED KITCHEN & BATHROOM and ample storage through. Warmed by GAS CENTRAL HEATING & DOUBLE GLAZED. The property is perfectly located close to shops, parks, schools & excellent transport links!

Council Tax band: B

Tenure: Freehold

- Chain free property
- Perfect first time buy
- Two reception rooms
- Two bedrooms
- Fitted kitchen & bathroom
- Excellently located close to shops, parks & schools
- Surrounded by fantastic transport links
- Sizable rear garden with outbuilding as well as garden to the front

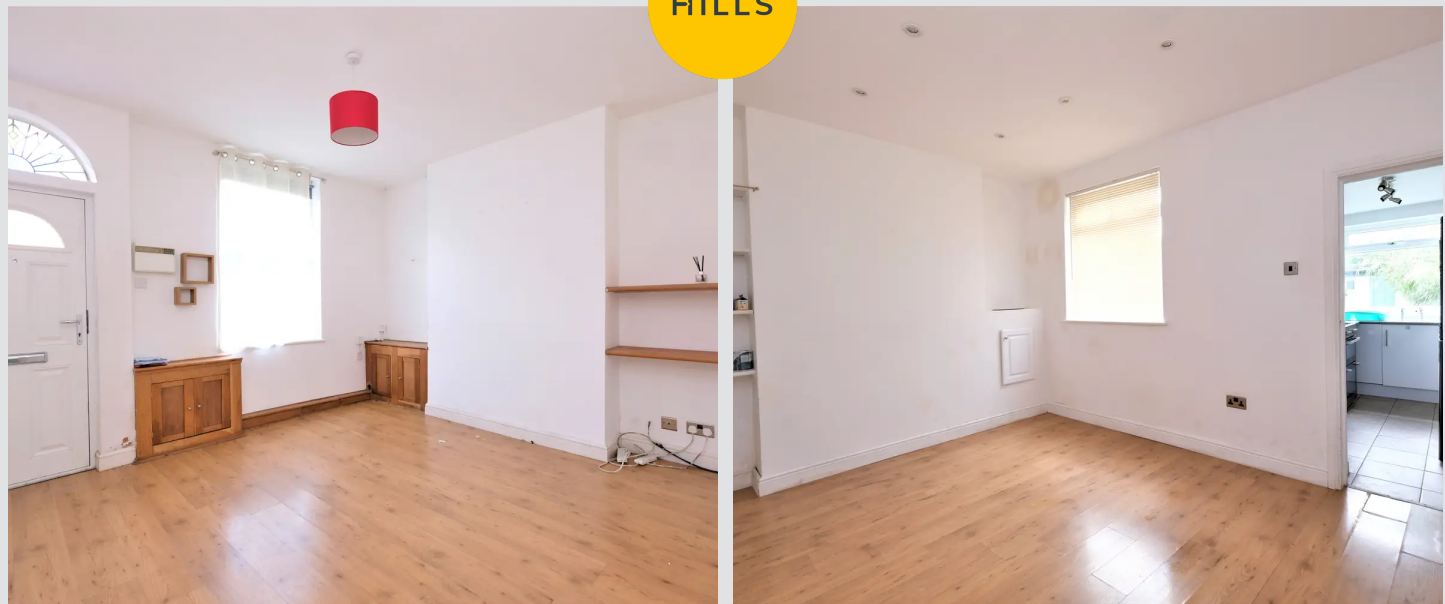

HILLS

Lounge

13' 3" x 11' 8" (4.04m x 3.56m)

Ceiling light point, double glazed window, wall mounted radiator, power point and alarm control.

Dining Room

12' 4" x 9' 7" (3.76m x 2.92m)

Ceiling spotlights, double glazed window, wall mounted radiator, power points, storage and entrance into kitchen.

Kitchen

10' 8" x 6' 3" (3.25m x 1.91m)

Fitted with a range of wall and base units with complementary work surfaces and integrated sink and drainer unit. Space for a washer, cooker and fridge freezer. Ceiling light point, double glazed window, wall mounted radiator and pvc door to the rear garden.

Landing

Ceiling light point, double glazed window and access to bedrooms and bathroom.

Bedroom One

13' 5" x 11' 9" (4.09m x 3.58m)

Ceiling light point, double glazed windows, wall mounted radiator, power point and built-in wardrobes.

Bedroom Two

11' 5" x 6' 7" (3.48m x 2.01m)

Ceiling light point, double glazed windows, wall mounted radiator and power point.

Bathroom

6' 8" x 5' 8" (2.03m x 1.73m)

Fitted with a three piece suite including a hand wash basin, WC and bath with overhead shower. Ceiling spotlights, double glazed window and heated towel rail.



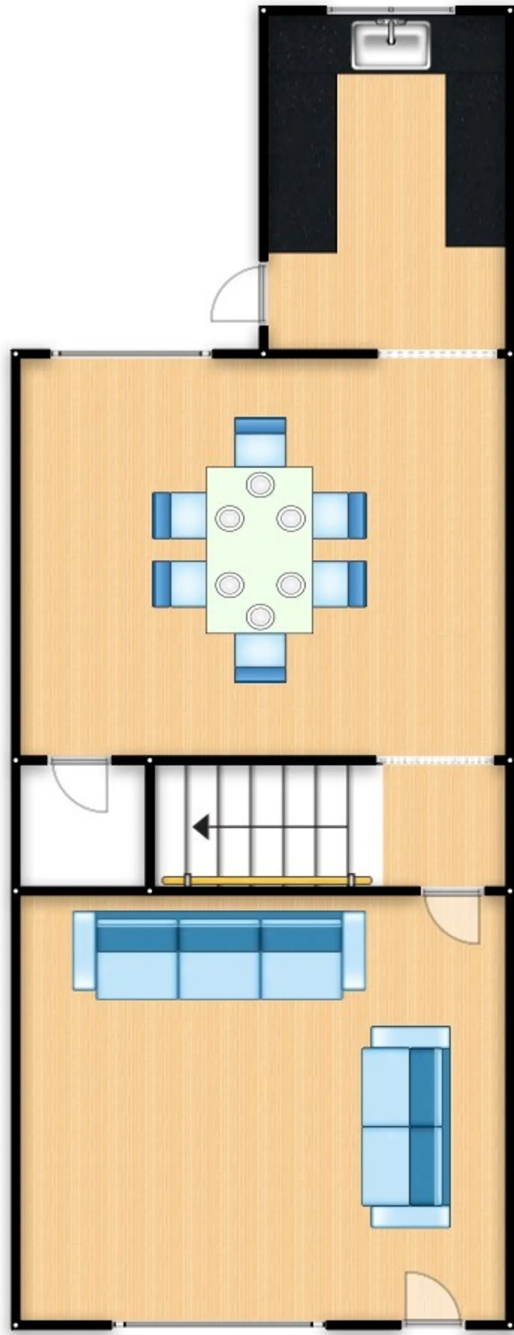



Hills | Salfords Estate Agent

Hills Residential, Sentinel House Albert Street – M30 0SS

0161 707 4900

sales@hills.agency

www.hills.agency/



THE PROPERTY MISDESCRIPTIONS ACT 1991 The Agent has not tested any apparatus, equipment, fixtures and fittings or services and so cannot verify that they are in working order or fit for the purpose. A Buyer is advised to obtain verification from their Solicitor or Surveyor. References to the Tenure of a Property are based on information supplied by the Seller. The Agent has not had sight of the title documents. A Buyer is advised to obtain verification from their Solicitor. You are advised to check the availability of this property before travelling any distance to view. Every effort and precaution has been made to ensure these particulars are correct and not misleading but their accuracy is not guaranteed nor do they form part of any contract. If there is any point which is of particular importance to you, please contact us and we will provide any information you require. This is advisable, particularly if you intend to travel some distance to view the property. The mention of any appliances and services within these details does not imply that they are in full and efficient working order. These particulars are in draft form awaiting Vendors confirmation of their accuracy. These details must therefore be taken as a guide only.