



Leamington Road, Eccles

Manchester



In Excess of £360,000

# Leamington Road

Eccles, Manchester

Take a look at this BEAUTIFULLY PRESENTED, EXTENDED FOUR BEDROOM SEMI-DETACHED HOME! Featuring a downstairs W.C, STUNNING FITTED KITCHEN AND BATHROOM, FOUR GENEROUS SIZED BEDROOMS AND OFF-ROAD PARKING

Council Tax band: C

Tenure: Leasehold

- Four bedroom semi-detached family home!
- Located close to excellent schooling, good transport links and Monton Village
- Double story side extended and single story rear extended!
- Contemporary fitted kitchen complete with breakfast bar
- Spacious lounge and separate reception room with bi-folding doors opening to the rear garden
- Off-road parking to the front
- Downstairs W.C. and modern bathroom suite
- Well-presented throughout
- Perfect family home
- Early viewing is essential!



HILLS



**Entrance Hallway**

7' 7" x 9' 1" (2.32m x 2.77m)

**Lounge**

10' 11" x 18' 3" (3.32m x 5.56m)

**Kitchen**

9' 9" x 19' 4" (2.96m x 5.90m)

**Dining Room / Extension**

17' 0" x 8' 8" (5.18m x 2.65m)

**Landing**

**Bedroom One**

11' 10" x 9' 11" (3.61m x 3.01m)

**Walk In Wardrobe**

7' 9" x 9' 11" (2.37m x 3.01m)

**Bedroom Two**

10' 11" x 8' 9" (3.34m x 2.67m)

**Bedroom Three**

7' 11" x 7' 3" (2.41m x 2.22m)

**Bathroom**

5' 2" x 6' 8" (1.57m x 2.02m)



HILLS





HILLS



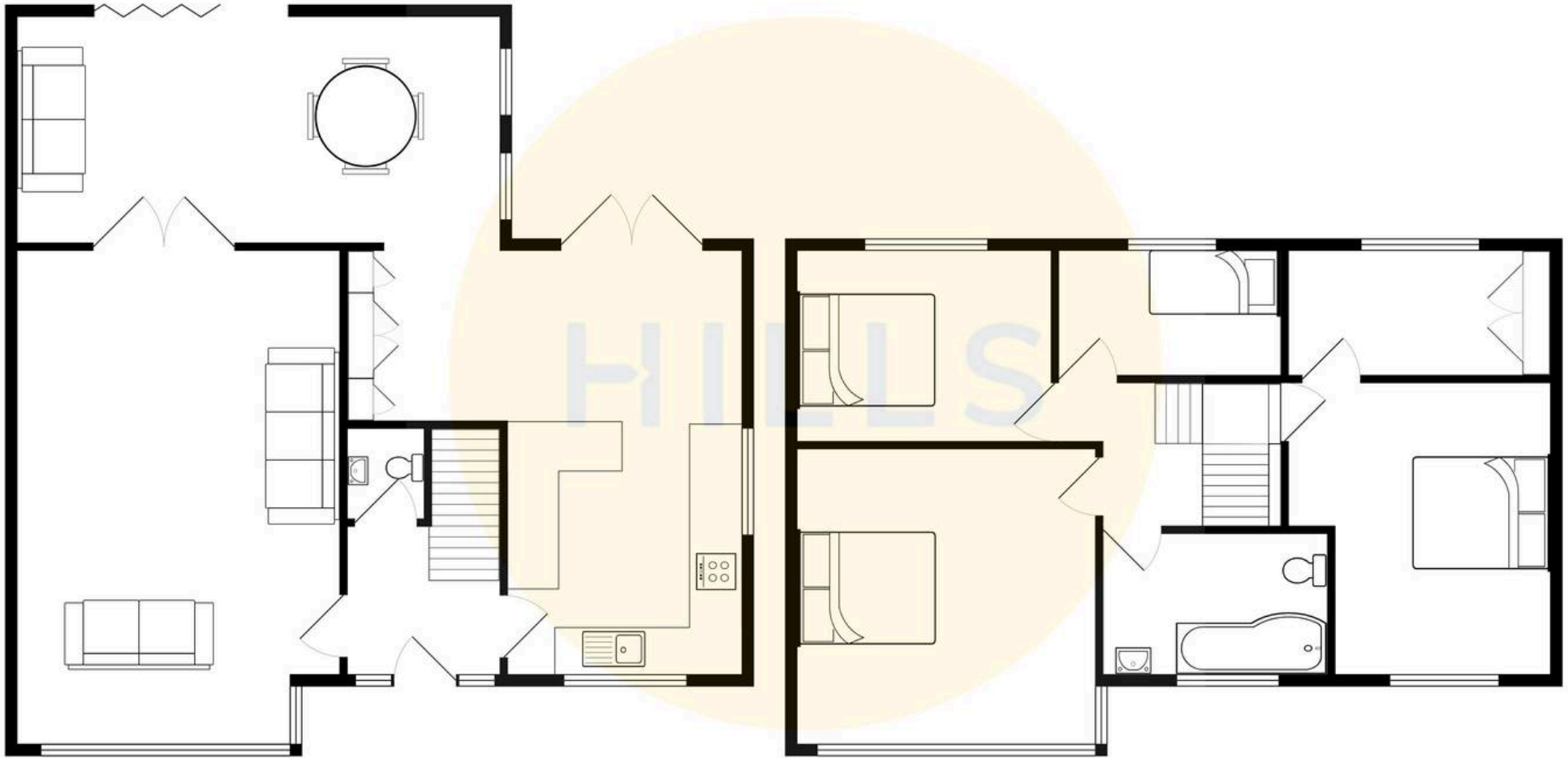



## Hills | Salfords Estate Agent

Hills Residential, Sentinel House Albert Street - M30 0SS

0161 707 4900

[sales@hills.agency](mailto:sales@hills.agency)

[www.hills.agency/](http://www.hills.agency/)



By law, we are required to conduct anti-money laundering checks on all potential buyers and sellers. In line with HMRC guidelines, our trusted partner, Coadjute, will securely manage these checks on our behalf. A non-refundable fee of £45 + VAT per person will apply, and Coadjute will handle the payment. Once an offer is accepted, Coadjute will send a secure link for you to complete the biometric checks. These checks must be completed before we can send the memorandum of sale to all parties. PLEASE NOTE: The Agent has not tested any equipment, fixtures, fittings or services so cannot verify that they are in working order or fit for the purpose. References to the properties tenure are based on information supplied by the seller. You are advised to check the availability of this property before travelling any distance to view. Every effort has been made to ensure these particulars are correct and not misleading but their accuracy is not guaranteed nor do they form part of any contract.