



The Hollies, Eccles Old Road

Salford



Offers Over £170,000

The Hollies

Salford

Beautifully Presented Two Bedroom Apartment,
Tucked Away at the End of a Quiet, Beautifully
Presented Development that Boasts Plenty of
Greenery - Within Walking Distance of Salford Royal
Hospital!

Council Tax band: A

Tenure: Leasehold

- Beautifully Presented Two Bedroom First Floor Apartment
- Tucked Away at the End of a Peaceful Development
- Within Walking Distance of Salford Royal Hospital and Buile Hill Park
- Within Easy Access of Ladywell Tram Stop, which Provides Direct Access into Salford Quays, Media City and Manchester City Centre
- Two Well-Proportioned Bedrooms
- Large Lounge Diner
- Modern Fitted Kitchen with Views Over the Development
- Contemporary Three-Piece Bathroom
- Ideal First Time Home or Investment
- Viewing is Highly Recommended!

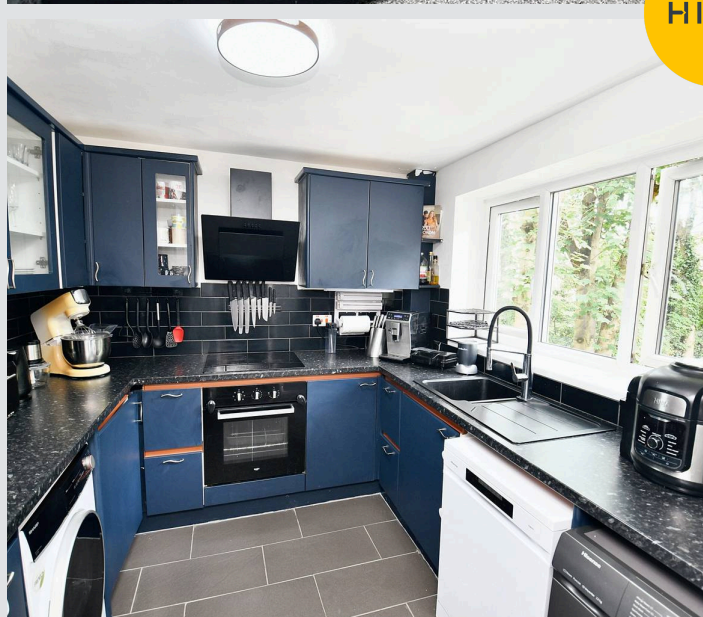

Entrance Hallway

Lounge / Diner

16' 1" x 12' 6" (4.91m x 3.82m)

Kitchen

9' 3" x 8' 5" (2.83m x 2.57m)

Bedroom One

13' 0" x 9' 3" (3.97m x 2.82m)

Bedroom Three

9' 5" x 9' 3" (2.87m x 2.81m)

Bathroom

7' 7" x 6' 0" (2.31m x 1.83m)



HILLS



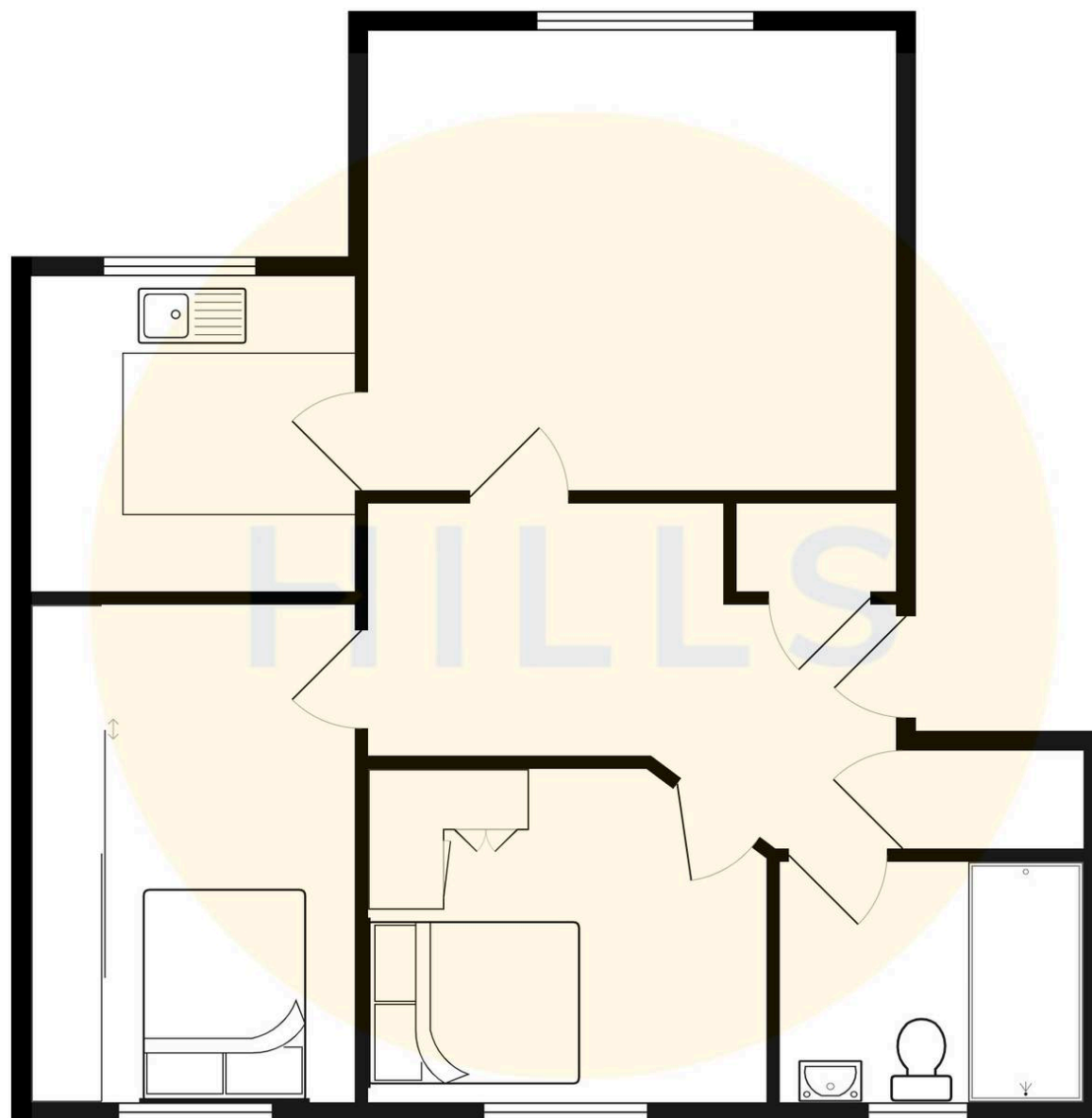



Hills | Salfords Estate Agent

Hills Residential, Sentinel House Albert Street – M30 0SS

0161 707 4900

sales@hills.agency

www.hills.agency/



THE PROPERTY MISDESCRIPTIONS ACT 1991 The Agent has not tested any apparatus, equipment, fixtures and fittings or services and so cannot verify that they are in working order or fit for the purpose. A Buyer is advised to obtain verification from their Solicitor or Surveyor. References to the Tenure of a Property are based on information supplied by the Seller. The Agent has not had sight of the title documents. A Buyer is advised to obtain verification from their Solicitor. You are advised to check the availability of this property before travelling any distance to view. Every effort and precaution has been made to ensure these particulars are correct and not misleading but their accuracy is not guaranteed nor do they form part of any contract. If there is any point which is of particular importance to you, please contact us and we will provide any information you require. This is advisable, particularly if you intend to travel some distance to view the property. The mention of any appliances and services within these details does not imply that they are in full and efficient working order. These particulars are in draft form awaiting Vendors confirmation of their accuracy. These details must therefore be taken as a guide only.